



Jefferson/Hood Street Surface Water Interceptor Project

CONSTRUCTION NOTICE – NIGHT WORK

NIGHT WORK AT S 17TH ST AND PACIFIC AVE ANTICIPATED TO START MARCH 19 AT 10 P.M.

Crews working for the City of Tacoma are relocating a sanitary sewer pipe along S 17th St between Pacific Ave and Commerce St. The work is located near a Sound Transit light rail power pole. To maintain safety of the crew and stability of the light rail pole, Sound Transit will deactivate the Link light rail between 10 p.m. and 7 a.m. so crews can safely complete utility work outside of peak traffic hours. This work will be noisy and is anticipated to last up to 5 days. This after-hour work has been approved by a City of Tacoma noise variance. We apologize for any inconvenience and appreciate your patience.

After sanitary sewer relocation, crews will return to excavate two large diameter pits that will be entry and receiving shafts for the installation of a new 72-inch stormwater pipeline underneath Pacific Ave and the Link light rail crossing. A large pit will be constructed at the south end of Prairie Line Trail and a second large receiving pit will be constructed at S 17th St and Pacific Ave. Construction will require full road closures, trail closures, lane restrictions, and detours through summer 2022.

Reverse page for full project map and learn about project benefits.

Location

This work is located at S 17th and Pacific Ave. Please see the map for an approximate location.

Starting in April or May 2022: Crews will return to excavate large pits for trenchless construction under Pacific Ave and the Link light rail crossing. See map for approximate location. Construction activity is expected to continue through mid-2022. As early as summer 2022, crews will return to restore the roadway and Prairie Line Trail.

Note that the start date, duration, and work hours are subject to change due to permitting, weather, and other factors.

What to expect during construction

- Nighttime work hours, 10 p.m. – 7 a.m., starting as early as March 19. This work is anticipated to last up to 5 days.
- Weekday construction activity will continue 7 a.m. – 5:30 p.m. through summer 2022.
- Heavy construction equipment, loud construction noise, dirt, and vibrations
- S 17th is closed between Pacific Ave and Commerce St. Through-traffic on Pacific Ave will be maintained.
- Detours, lane, and parking restrictions
- Access to adjacent businesses and University of Washington Tacoma parking lot will be maintained
- Access to Link light rail, trail, and sidewalk from S 17th St will close to people who walk, roll, and bike. Follow sidewalk detours at the Tacoma Art Museum crossing and Sound Transit crossing near Washington State History Museum.



For more project information

Hotline: 253-279-5509

Website: cityoftacoma.org/jeffersonhood

Email: JeffersonHoodProject@cityoftacoma.org

Kennedy/Jenks
Consultants



SURFACE WATER SOLID WASTE WASTEWATER
ENVIRONMENTAL SERVICES DEPARTMENT



Jefferson/Hood Street Surface Water Interceptor Project

CONSTRUCTION NOTICE – NIGHT WORK

About the project

The City of Tacoma is installing a large, 72-inch diameter stormwater interceptor pipe and a new outfall into the Thea Foss Waterway. This project will improve existing storm, sewer and system capacity, help reduce flooding events, and support sustainable future growth in the downtown area.

Construction crews will dig up the road to expose the underground water system and install the widened stormwater pipe. Crews will take the opportunity to update existing, aging sewer lines while conducting stormwater system improvements and prevent the need to return for later work.

Increasing stormwater and wastewater capacity downtown will provide opportunities for economic development and operational improvements within our community. For example, local residences and businesses will experience increased protection against property damage caused by flooding, and system support for potential population and service growth. Following project completion, drivers will experience fewer traffic disruptions caused by flooding in downtown Tacoma.

All work will occur in city right-of-way along S 19th St, Jefferson Ave, S 17th St, Prairie Line Trail, S 15th St and A St, and Dock Street. This work is anticipated to be complete by fall 2022.

Construction methods

Most of the sewer pipe will be installed using open-cut construction. In open-cut construction, crews dig from the surface to the pipe depth, lay the pipe, then cover the pipe and restore the surface.

There are three areas that require a trenchless or “tunneling” method to install the pipeline. This tunneling method does not require digging from the surface to the pipe depth. After two large shafts are built on either end of the pipe, the pipe is installed using a hammer, auger, drill, or tunneling machine. Due to the need to hammer the pipe into place, this work will be loud.

Trenchless construction will be used under Dock Street, the BNSF railroad tracks, and the Link Light Rail crossing on Pacific Ave. See the project overview map for approximate locations for open-cut and trenchless construction.

Project map

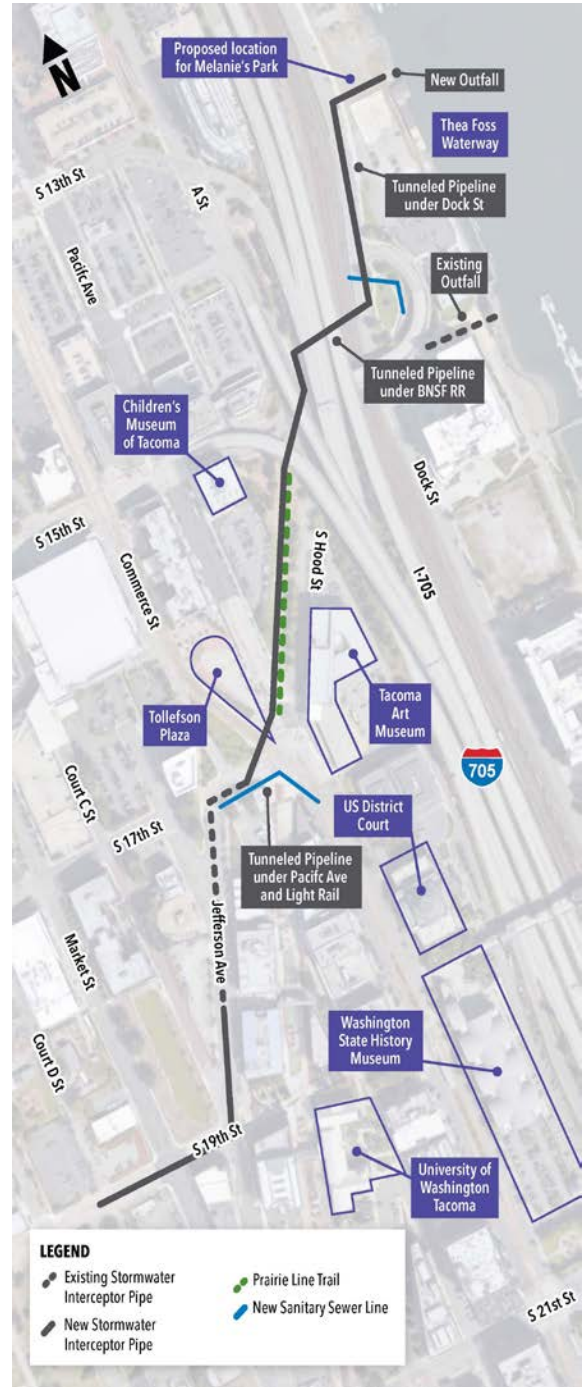

For more project information

Hotline: 253-279-5509

Website: cityoftacoma.org/jeffersonhood

Email: JeffersonHoodProject@cityoftacoma.org



SURFACE WATER SOLID WASTE WASTEWATER
ENVIRONMENTAL SERVICES DEPARTMENT